



2 LIGHT SLIDER

THE ENERGY KING
Windows & Doors

Pro152



Features

- **STANDARD STRENGTH** insulated **LOW-E** with **ARGON GAS** glass sealed including **SUPER SPACER®** technology
- **SILL EXTENSION** with dual durometer for ease of installation
- **EXTRUDED** ½ screen with **BETTER VUE®** screening provides improved visibility, enhanced insect performance, air flow and light transmission
- **INTERNAL ALUMINUM REINFORCEMENT**
- **FULLY WELDED FRAME & SASH**
- **BOTH SASHES SLIDE**
- **FULL INTERLOCK AT THE MEETING RAIL**
- Energy Efficient **FOAMED PROFILES**
- **LIFT OUT SASH** for easy cleaning from the inside
- **DOUBLE LOCKS** included on heights of 27½" and over
- **3¼" FULLY WELDED FRAME**
- **UPGRADE to ENERGY STAR V7 with TRIPLE GLAZING**

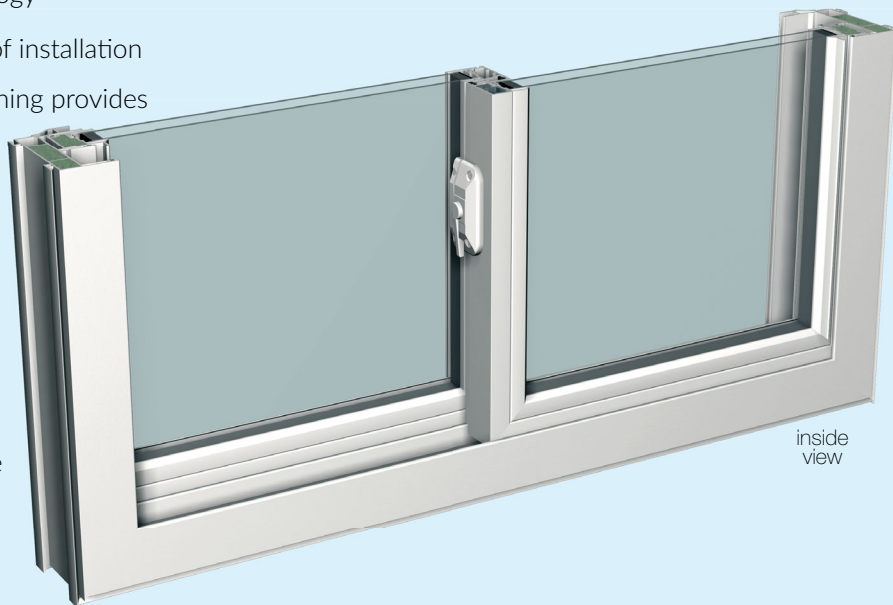

MANUFACTURING LIMITS

MANUFACTURING INCREMENTS - WIDTH AND HEIGHT EVERY ¼" INCH

MINIMUM WIDTH 24½" MINIMUM HEIGHT 14½"

MAXIMUM WIDTH 76" MAXIMUM HEIGHT 64"

MAXIMUM WIDTH + HEIGHT = 128" UI

Think about this:

The **spacer system** you choose is just as important as the window!

That's why we use:

Super Spacer®
SEALED

Window Options

EXTERIOR PAINTED COLORS

(interior color is white or wood grain)



INTERIOR WOOD GRAIN COLORS

(wood grain color choices - natural oak or cherry)

NATURAL OAK

CHERRY

STANDARD STRENGTH TRIPLE PANE

Two panes of Low-E glass and one pane of clear glass with argon gas in both chambers

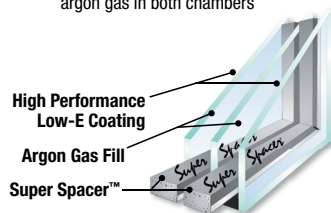

Privacy Plus Performance

OBSCURED GLASS



Grids are installed between the glass panes during manufacturing for easy cleaning

GRIDS PATTERNS AVAILABLE



CONTOUR GRIDS



FLAT GRIDS



FINGER JOINT PRIMED EXTENSION JAMBS



NAILING FIN

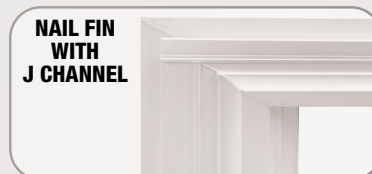

NAIL FIN WITH J CHANNEL